

- 1 Fix treated timber battens (25x38mm) vertically at a maximum of 600mm centres.
- 2 Prepare and fix all trims in to place where required (right).
- 3 Starting from the bottom, cut down and fix the cladding boards. Deduct 5mm from the edge of the board to allow for expansion. Fix the cladding boards from the centre and work outwards using 30mm stainless steel cladding pins (non-Liniar supply).
- 4 When using butt joints, stagger per length and position where a batten is located. Secure the mouldings by glueing one side to the cladding board.
- 5 Once all the boards are fixed, push the second part of the corner trim in to it's counterpart.

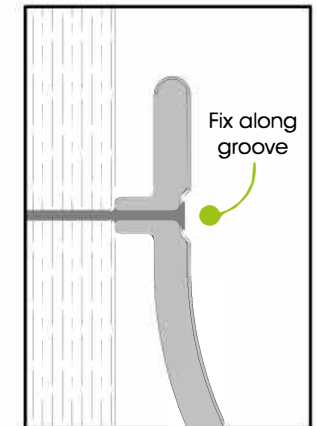
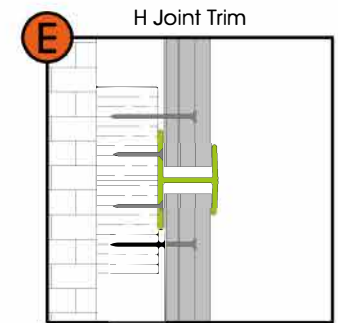
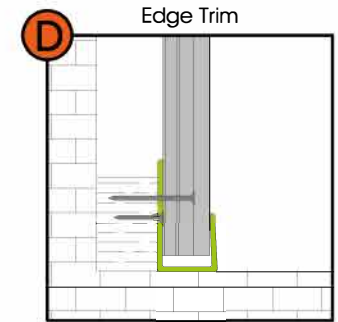
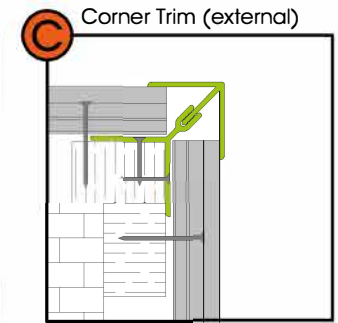
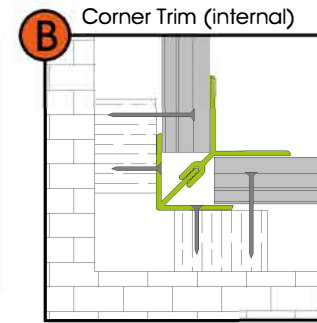
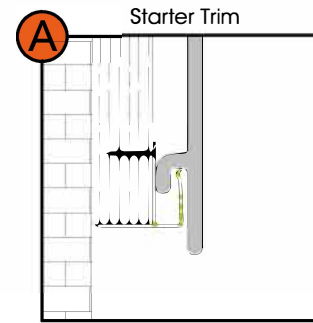
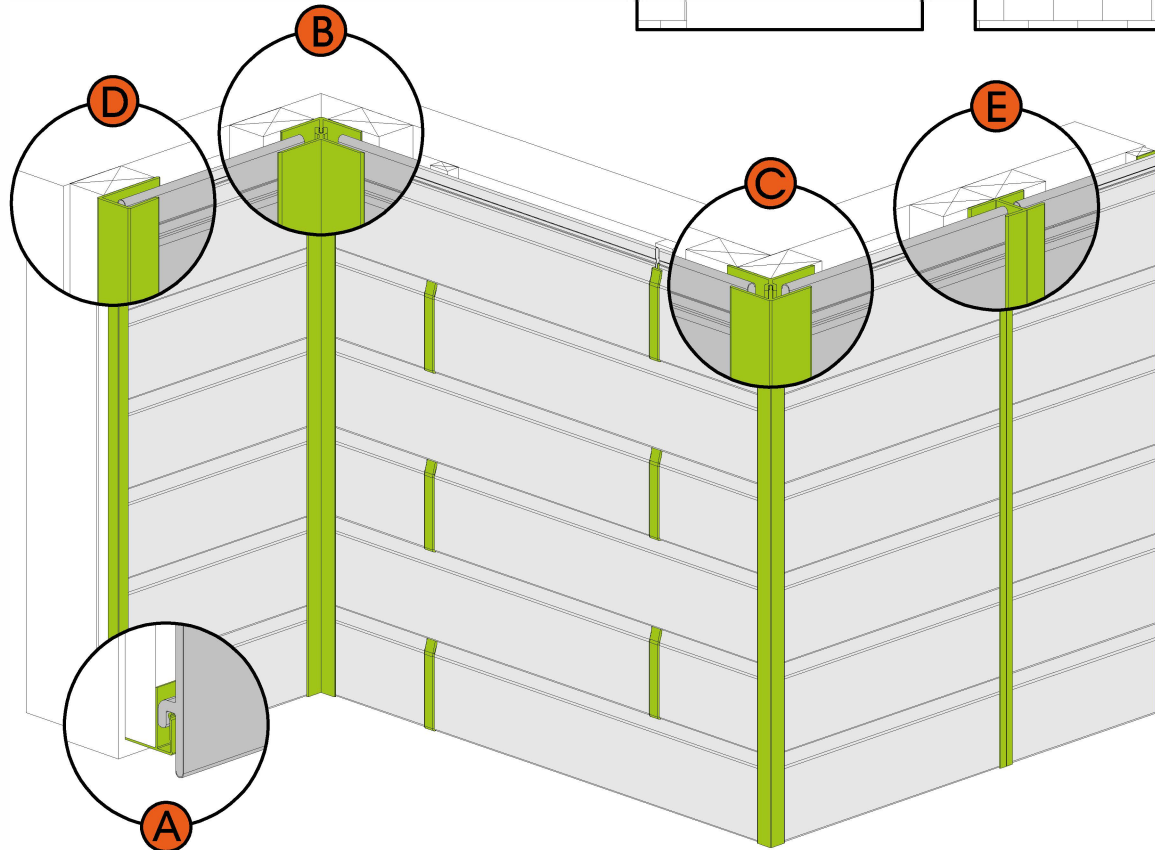

Please note...

- If the site is in exposed areas, reduce centres to 400mm.
- Always ensure there is a 25mm air gap between cladding board and substrate.
- Optional breather membrane (non-Liniar supply) can be used between substrate and battens.
- If the top board requires cutting, pack behind the board to keep it flush.
- Foiled cladding should be fitted at a maximum length of 2.5m.